

(replaces datasheets 1022/41 and 39)

### General description

The HG range of high expansion foam generators are generally designed for use within Skum HotFoam™ systems.

### Application description

HG foam generators are used within 'inside air' applications, for the protection of enclosed spaces and are suitable for installations in warehouses, flammable liquid stores, tunnels and marine engine and pump rooms.

### Product features

- All stainless steel body and bronze nozzle
- Low weight
- Easy to install
- Large area coverage
- Suitable for indoor and outdoor use
- 1" mounting flange included

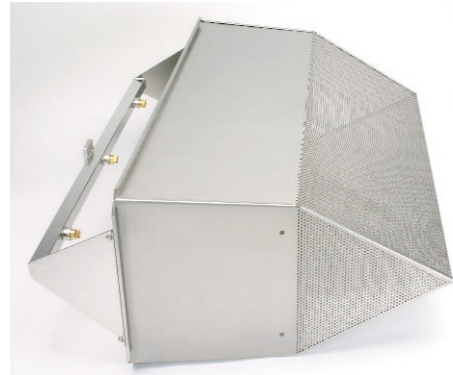

### Listings or approvals

- Det Norske Veritas (DNV)
- Lloyd's Register of Shipping (LRS)
- Bureau Veritas (BV)
- Germanischer Lloyd (GL)
- American Bureau of Shipping (ABS)
- China Classification Society (CCS)

#### Performance Data

##### HG-25

Nominal rating	At inlet pressure of 6 bar the solution consumption is 90 l/min and the foam capacity is 60 m <sup>3</sup> /min expansion ratio 667:1
Material	Stainless steel
Weight	10 kg / 22 lbs

1 bar = 0,1 MPa = 14,5 psi

##### HG-25

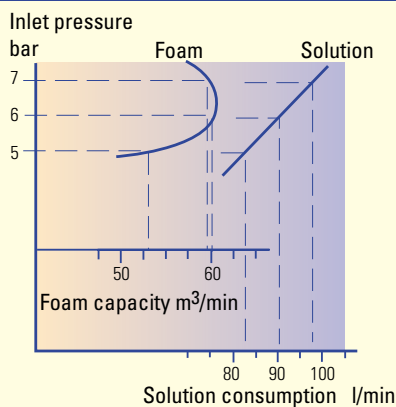

##### HG-25

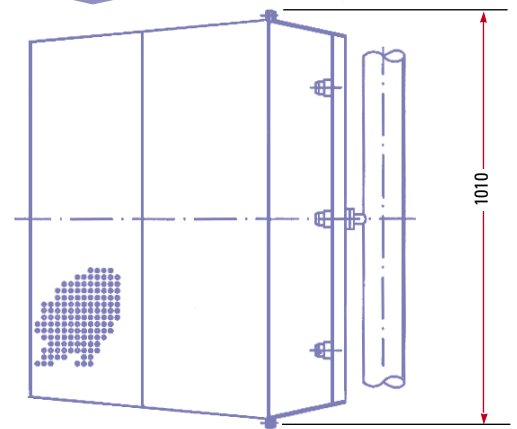

##### HG-15 and 25

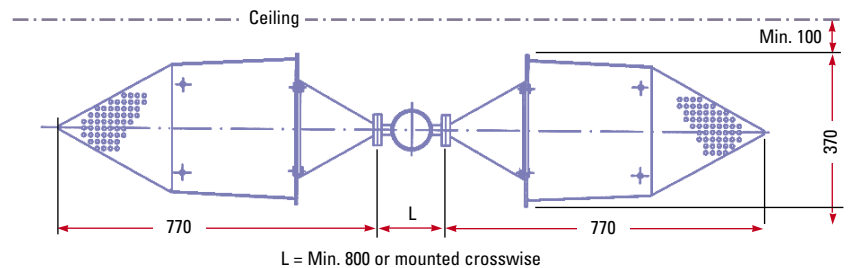

# High Expansion Foam Generator HG

Datasheet 1022/50  
Page 2 of 2

(replaces datasheets 1022/41 and 39)

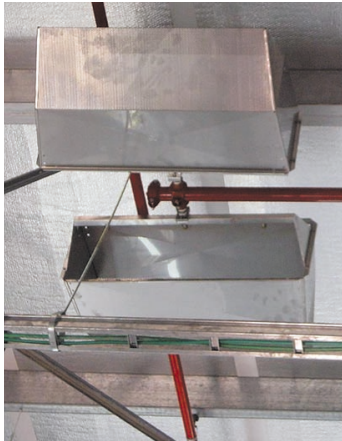

## HG-15

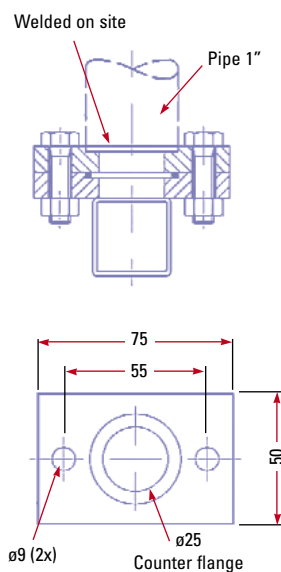
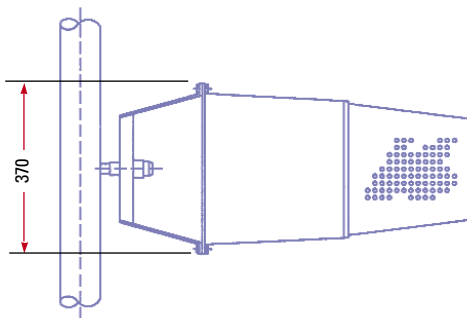

## HG-15

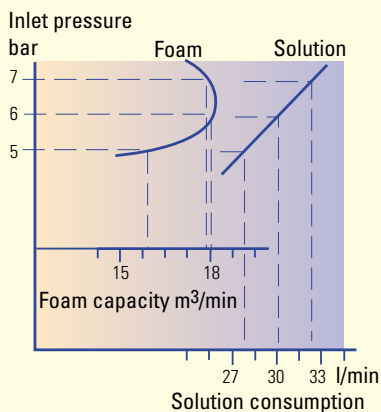

### Performance Data

#### HG-15

Nominal rating	At inlet pressure of 6 bar the solution consumption is 30 l/min and the foam capacity is 18 m <sup>3</sup> /min expansion ratio 600:1
Material	Stainless steel
Weight	5 kg / 11 lbs

1 bar = 0,1 MPa = 14,5 psi



www.skum.com

tyco Fire Suppression  
& Building Products

Technical changes reserved without notice Copyright © 2007 Tyco Safety Products

Datasheet Ref. SKM0005 DSA1